

COLOR CARD HEARTS

Designed by Elise Lea RK
www.robertkaufman.com

Featuring **KONA**[®]
cotton solids



2021
KONA[®]
cotton solids
365
CALENDAR
QUILT

Finished quilt measures: 80" x 86"







Difficulty Rating: **Beginner**

ROBERTKAUFMAN
F A B R I C S

For questions about this pattern, please email Patterns@RobertKaufman.com.

Fabric and Supplies Needed

Fabric amounts based on yardage that is 42" wide.

Color	Fabric	Name/SKU	Yardage	Color	Fabric	Name/SKU	Yardage
		CHS-851-42 NEW COLORS 2019	one Charm Square Pack			CHS-692-85 PASTEL COLORSTORY	one Charm Square Pack
		CHS-693-85 BRIGHT COLORSTORY	one Charm Square Pack		A	K001-1333 SILVER	6 yards
		CHS-694-85 DARK COLORSTORY	one Charm Square Pack		Binding	K001-854 OVERCAST	2/3 yard
		CHS-695-85 NEUTRAL COLORSTORY	one Charm Square Pack	<p>You will also need: 7-3/8 yards for backing</p>			
<p>Copyright 2020, Robert Kaufman For individual use only - Not for resale</p>							

Notes Before You Begin

- Read through all of the instructions before beginning.
- All of the seam allowances are 1/4" unless otherwise noted.
- Press seam allowances open unless otherwise noted.
- Width of fabric (WOF) is equal to at least 42" wide.
- Right sides together has been abbreviated to RST.
- Remember to measure twice and cut once!

Cutting Instructions

From each charm pack color, cut:

one 2-1/2" x 4-1/2" rectangle

Tip: The quilt is arranged in Color Card order. Arrange or label these rectangles in a way that helps you keep track of each color.

Note: Not all charm squares will be used. You will have 18 that are not used to make a heart. These colors are the doubles in the new colors charm pack, and the swatch in the neutral charm pack that matches the background fabric.

From Fabric A, cut:

thirty-four 2-1/2" x WOF strips. Sew together, end-to-end in pairs, then trim:

thirteen 2-1/2" x 76-1/2" row sashing strips

two 2-1/2" x 82-1/2" side outer borders

two 2-1/2" x 80-1/2" top/bottom outer borders

forty-two 2-1/2" x WOF strips. Subcut:

one hundred sixty-eight 2-1/2" x 4-1/2" block sashing strips

three hundred sixty-four 2-1/2" squares for the heart block bottoms

nineteen 1" x WOF strips. Subcut:

seven hundred twenty-eight 1" squares

From the Binding Fabric, cut:

nine 2-1/2" x WOF strips

Assemble the Heart Block

Note: You may choose to mark the back of each 1" and 2-1/2" Fabric A square on the diagonal, or you may choose to eyeball these lines as you sew.

Note: The colors follow the color card order in groups of two, with some slight shuffling of the order here and there. Whichever color is lighter, between the two fabrics in the pair, will go on the left and the darker fabric will go on the right.

Step 1: Place a 1" Fabric A square in the upper right corner of a 2-1/2" x 4-1/2" rectangle from the Charm Packs, right sides together. Note the orientation of the marked diagonal line. Sew on the marked line, then trim away the excess fabric, leaving a 1/4" seam allowance. Press. Repeat on the upper left corner with another 1" Fabric A square.

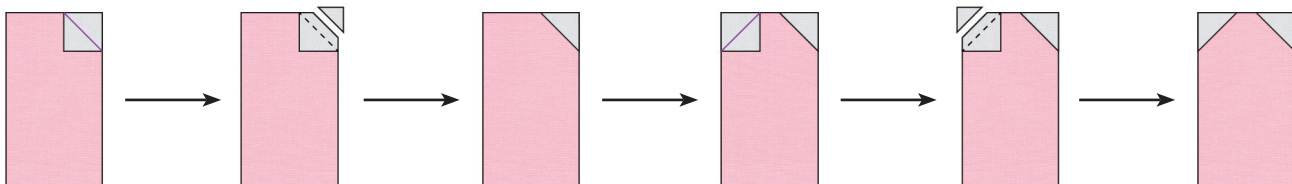

Step 2: Place a 2-1/2" Fabric A square at the lower edge of the unit, right sides together. Note the orientation of the marked diagonal line. Sew on the marked line, then trim away the excess fabric, leaving a 1/4" seam allowance. Press.

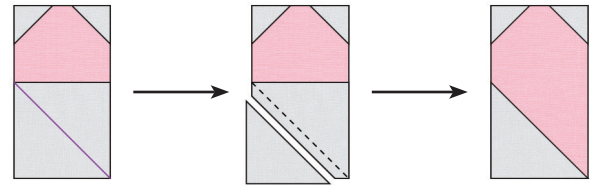

Step 3: Select the 2-1/2" x 4-1/2" rectangle that will become a heart when paired with the completed Step 2 unit. Repeat Step 1. Repeat Step 2, but sew along the diagonal in a mirror image from Step 2, to create the heart.

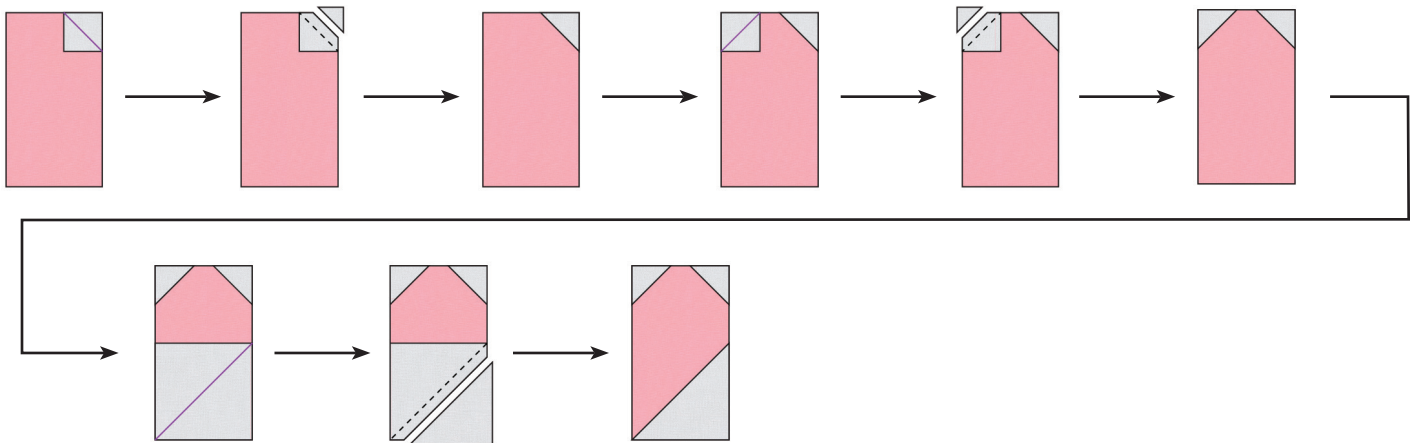

Step 4: Sew the completed Step 2 and Step 3 units together to make the Heart Block. The Heart Block should measure 4-1/2" square.

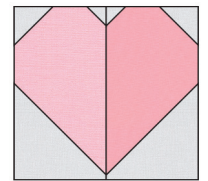

Repeat Steps 1-4 to make a total of one hundred eighty-two Heart Blocks.

Assemble the Quilt



Step 5: Arrange the Heart Blocks together as indicated in the Quilt Assembly Diagram. Feel free to move the colors around a bit to get a look that is pleasing to your eye. Sew each row together, using block sashing strips between each block. Press seams toward the sashing. Repeat to make thirteen block rows.

Step 6: Sew the Heart Block rows together, sewing a row sashing strip between each row. Press seams open or to the sashing.

Step 7: Sew the side outer borders to the sides of the quilt center. Press toward the borders. Sew the top and bottom outer borders to the quilt center. Press toward the borders.

Your quilt top is complete! Baste, quilt, bind and enjoy!

This pattern may be used for personal purposes only and may not be reproduced in any form without the express permission from Robert Kaufman Fabrics. This pattern is not for resale. All patterns, unless otherwise attributed, are © Robert Kaufman Co., Inc. 2005-2020. All rights reserved.